



**California Traffic Control Devices Committee (CTCDC)  
Agenda Item Report**



<b>Meeting Date:</b> November 7, 2024	<b>From:</b> Tasha Higgins, Caltrans
<b>Item Number:</b> 24-15	
<b>Sponsored By:</b> Amjad Obeid, Caltrans	<b>Presented By:</b> Tasha Higgins and Johnny Bhullar, Caltrans
<b>Description:</b> Caltrans plans to adopt a supplement to the Manual on Uniform Traffic Control Devices (MUTCD) 11th Edition for the 2028 Olympic and Paralympic Games. This Supplement LA28 is issued to prescribe uniform standards and specifications for all temporary traffic control device to be used during LA28 in locations specified by the supplement, in accordance with Section 21400 of the California Vehicle Code.	

**Recommendation:**

None.

**Agency Making Request/Sponsor:**

Tasha Higgins, Caltrans / Amjad Obeid, Caltrans

**Background:**

This item is being shared to provide information on the LA28 MUTCD Supplement that is being developed by Caltrans to allow the use of temporary traffic control devices in the Los Angeles region during the 2028 Los Angeles Olympics and Paralympics. This Supplement, when finalized, will be submitted as a request to experiment to this committee to seek review and recommendation before it is submitted to Federal Highway Administration for approval. This supplement will be revised to conform to the CA MUTCD 2026 Edition, which is being developed under a separate effort and planned to be issued on or before January 18, 2026.

2028 Los Angeles Olympics and Paralympics (LA28), which includes the Summer Olympics (July 14-30, 2028) and Summer Paralympics (August 15-27, 2028), will establish a Games Route Network (GRN) with dedicated lanes for Olympic Games vehicles to travel between venues and ensure athletes and accredited persons make their events and venues on time.

The GRN will utilize existing freeway/expressways, highways, and local roads to provide a safe, fast, and reliable transportation system. All LA28 traffic control devices will be installed and placed temporarily, from June 1, 2028, to September 1, 2028.

The Manual on Uniform Traffic Control Devices (MUTCD) 11th Edition California Supplement LA28 is issued to prescribe uniform standards and specifications for all temporary traffic control device to be used during LA28 in locations specified by the supplement, in accordance with Section 21400 of the California Vehicle Code.



## California Traffic Control Devices Committee (CTCDC) Agenda Item Report



Caltrans will engage local municipalities on the local arterial routes off the highways, to the sporting venues. Engagement will focus on the development of signs and messaging on local streets that will implement the dedicated lanes.

### **Attachments:**

Attachment A – The 2028 Olympic and Paralympic Games and the LA28 MUTCD Supplement presentation.



# ATTACHMENT A



California Traffic Control Devices Committee (CTCDC)  
Agenda Item Report



**Attachment A – The 2028 Olympic and Paralympic Games and the LA28 MUTCD Supplement presentation.**

*See following pages.*



# OLYMPIC & PARALYMPIC GAMES

---

CTCDC MEETING  
NOVEMBER 7, 2024

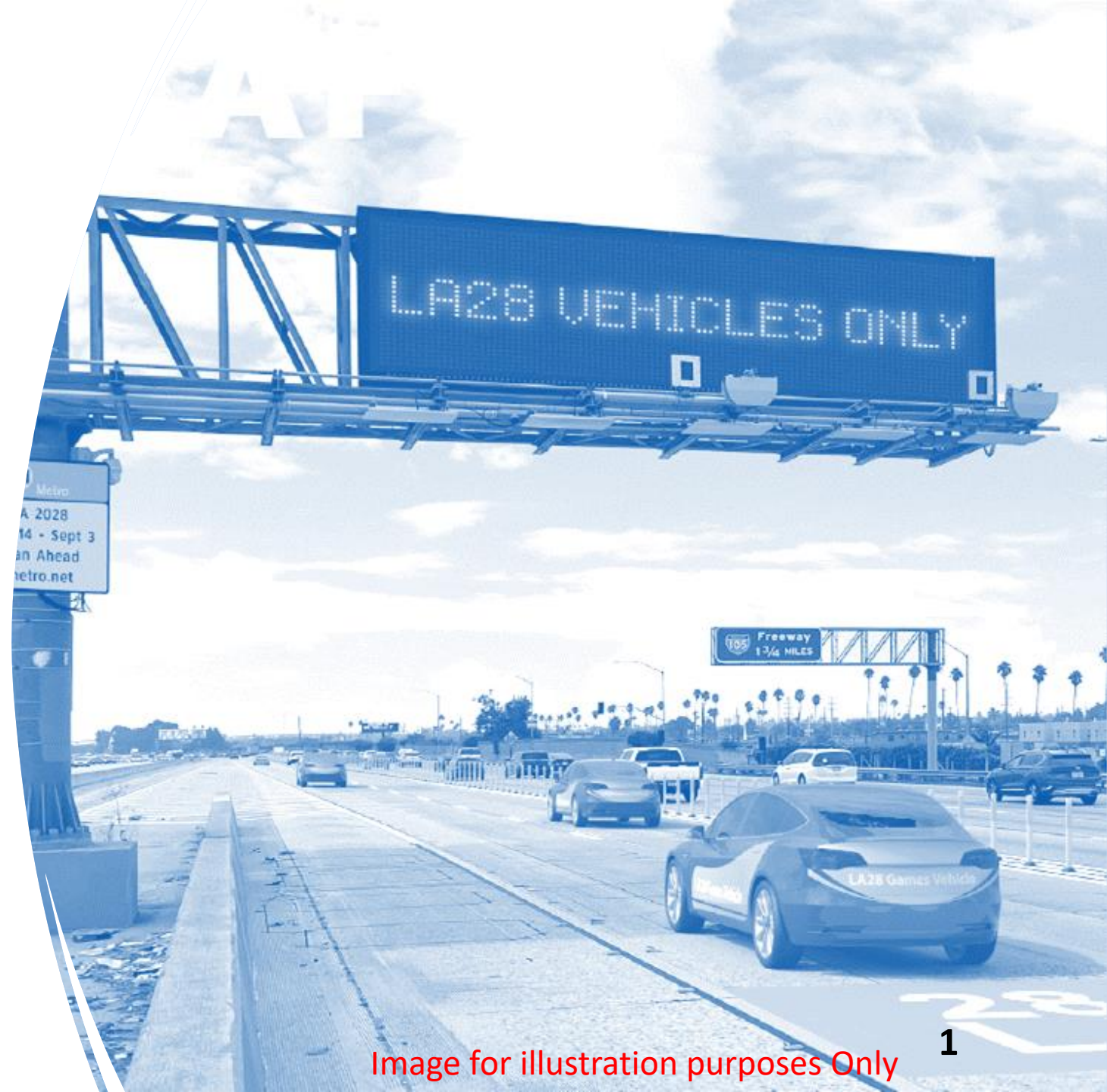

Image for illustration purposes Only



1344 days



# GAMES NUMBERS

\$10-15 million in ticket sales

~50,000 Athletes Media Officials



ATHLETES



TECHNICAL OFFICIALS



IOC/IPC STAKEHOLDERS



MEDIA & BROADCASTERS



ACCREDITED GUESTS



GAMES LOGISTICS



TICKETED SPECTATORS

~1.2 M Spectator trips per day



WORKFORCE

~65,000 Volunteers Employees

~100,000 Permitted vehicles



Estimates are confidential and subject to change



# GAMES ROUTE NETWORK (GRN)

- A GRN is a network of roads (approx. 720 miles) for traveling between official venues
- Dedicated lanes for the use of *Games Family* vehicles
- General traffic prohibited from using these dedicated travel lanes.
- Promotes a “Transit First” Games

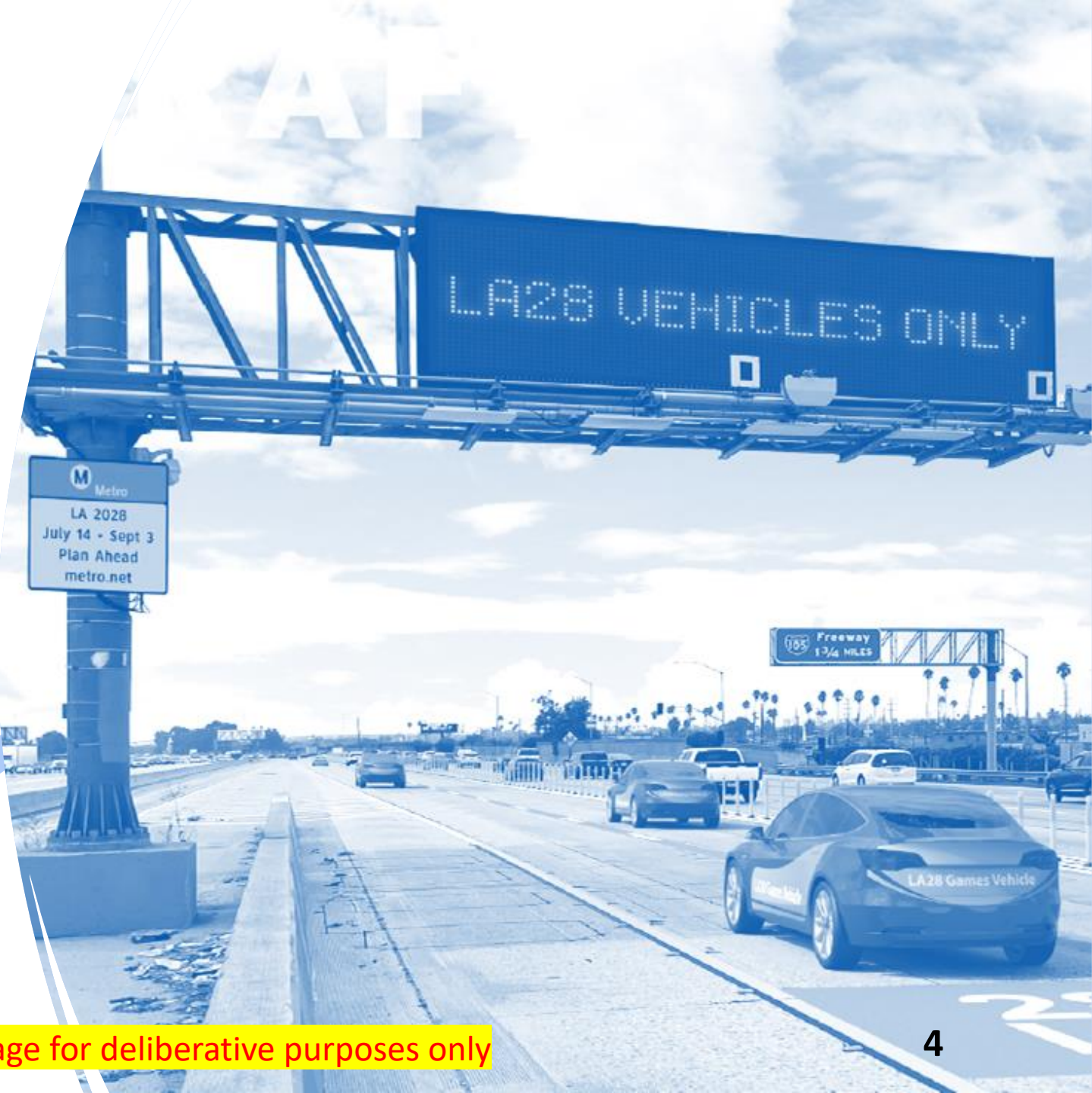

SAMPLE image for deliberative purposes only





# GRN SCOPE

- Shoulder Use
- Dedicated Express Lanes
- Dedicated HOV Lanes
- General Purpose Lanes
- Bus Only Lanes (local streets)
- Manual of Uniform Traffic Control Devices (MUTCD)
  - **MUTCD LA28 Supplement**



Image for illustration purposes Only



# INTERAGENCY COORDINATION (CURRENT/FUTURE)

## FEDERAL

- FHWA
- USDOT

## STATE

- CalSTA
- Caltrans District 7
- Caltrans District 8
- Caltrans District 12
- Caltrans Headquarters
- DMV
- CHP

## LOCAL/MUNICIPAL

- City of Los Angeles
  - Mayor's Office
  - LADOT
- Carson
- Inglewood
- Long Beach
- Hawthorne
- Pasadena
- San Dimas
- Chino
- Temecula
- Orange
- Huntington Beach
- Westminster

## REGIONAL/COUNTY

- SCAG
  - LA Metro
  - OCTA
  - RCTC
  - SBCTA
  - County of Los Angeles
- ## OTHER
- LA28



Caltrans



Venues



Alternate GRN



Primary GRN



NOTE: This is a draft and subject to change

# GRN AT PRIOR GAMES



Fixed temporary signage  
(London 2012)



Temporary patching of overhead  
gantry for GRN wayfinding  
signage (Glasgow 2014)



Variable message sign to activate Games  
Lane (Glasgow 2014)



Temporary striping /  
road marking

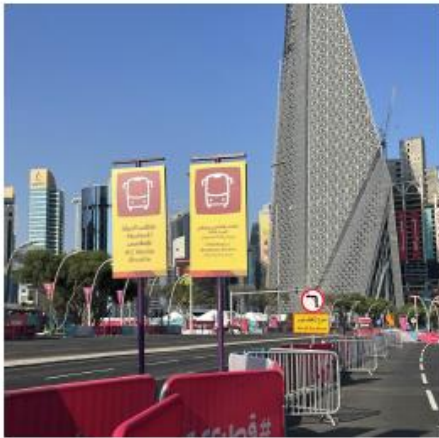

Fixed temporary signage  
(Qatar 2022)



Pavement striping  
(London 2012)



Fixed temporary signage  
(Vancouver 2010)



Temporary road closure to non-GRN traffic  
(2012 London)

# WORKPLAN

- ✓ Preliminary Traffic Analysis
- ✓ Working with FHWA for use regulatory conformance
  - MUTCD LA28 Supplement
  - Experimental Permit
- ✓ Groundwork for Construction Moratorium
- ✓ Initiated Legislative Amendment to SHC/CVC
  - Amendment to AB971 and use of lanes and definition of “Transit Only Lanes”
- ✓ Collaborating with local partners on seamless integration

## FREEWAY SIGNS



SGX-XX(LA28)

SAMPLE



SGX-XX(LA28)

SAMPLE

## ARTERIAL SIGNS

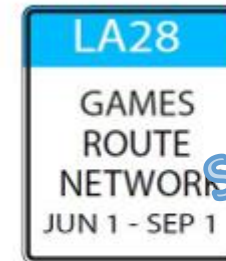

SRX-XX(LA28)



SRX-XX(LA28)

SAMPLE



# MUTCD CA SUPPLEMENT

- ✓ 1C.02 – Definition
  - ✓ Games Route Network – Network of existing roads connecting Los Angeles 2028 Summer Olympics and Paralympics competition and key non-competition venues involving a wide range of traffic management measures. As per CVC XXX, vehicles with a permit only will be allowed to use the network.
- ✓ 1C.03 – Abbreviation
  - ✓ GRN Games Route Network
  - ✓ LA28 Los Angeles 2028 Olympics and Paralympics
- ✓ 1D.05 – Color Code
  - ✓ Light Blue—temporary use for LA28 Games Route Network



**Table 2A-2. Common Uses of Sign Colors**

Type of Sign	Legend								Background												
	Black	Green	Red	White	Yellow	Orange	Fluorescent Yellow-Green	Fluorescent Pink	Black	Blue	Brown	Green	Orange <sup>6</sup>	Red <sup>1</sup>	White	Yellow <sup>1</sup>	Purple	Fluorescent Yellow-Green	Fluorescent Pink	Light Blue	
LA28 Only	X <sup>6</sup>			X <sup>6</sup>												X <sup>6</sup>					X <sup>6</sup>

<sup>6</sup> The use of light blue on signs is restricted per the provisions of Chapter 2G.

# MUTCD CA SUPPLEMENT

## ✓ 2G.1001 – Regulatory Signs & Plaques

Sign or Plaque	Sign Designation	Section	Conventional Road		Expressway	Freeway	Oversized
			Single Lane	Multi-Lane			
Games Route Network (post-mounted)	SRX-XX(LA28)	2G.1001	30 x 42	30 x 42	36 x 60	78 x 96	78 x 96
Right Lane Permit Only (post-mounted)	SRX-XX(LA28)	2G.1001	30 x 42	30 x 42	36 x 60	78 x 96	78 x 96
Permit Only Lane Entrance Direction (overhead)	SRX-XX(LA28)	2G.1002	78 x 48	114 x 72	144 x 84	150 x 108	150 x 108
Permit Only Begins XX Miles (overhead)	SRX-XX(LA28)	2G.1003	78 x 48	114 x 72	144 x 84	150 x 108	150 x 108
Permit Only Lane Entrance Direction (post-mounted)	SRX-XX(LA28)	2G.1004	—	—	186 x 108	186 x 108	—
Permit Only Lane Entrance Advance	SRX-XX(LA28)	2G.1005	—	—	186 x 96	186 x 96	—

Figure 2G-1001(LA28). Games Route Network Lane Regulatory Signs and Plaque (Sheet 1 of 3)

A - Barrier-mounted Games Route Network regulatory signs and plaque

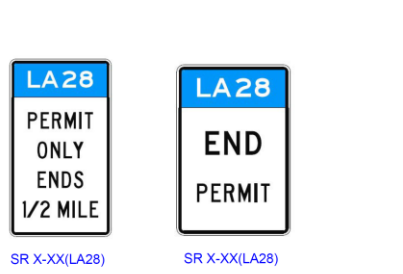

Figure 2G-1001(LA28). Games Route Network Lane Regulatory Signs and Plaque (Sheet 2 of 3)

B - Overhead Games Route Network regulatory signs

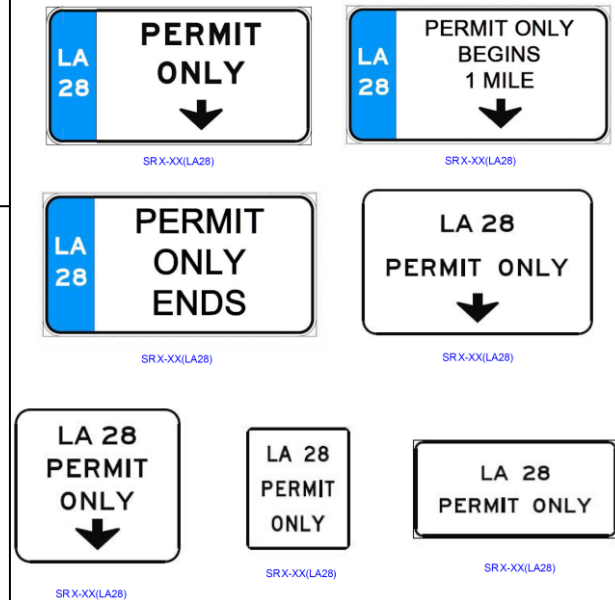

Figure 2G-1001(LA28). Games Route Network Lane Regulatory Signs and Plaque (Sheet 3 of 3)

C - Post-Mounted Arterial Street Games Route Network regulatory signs and plaques

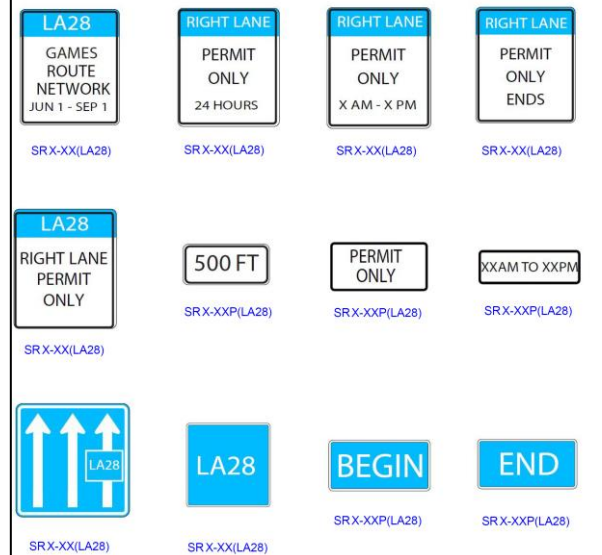
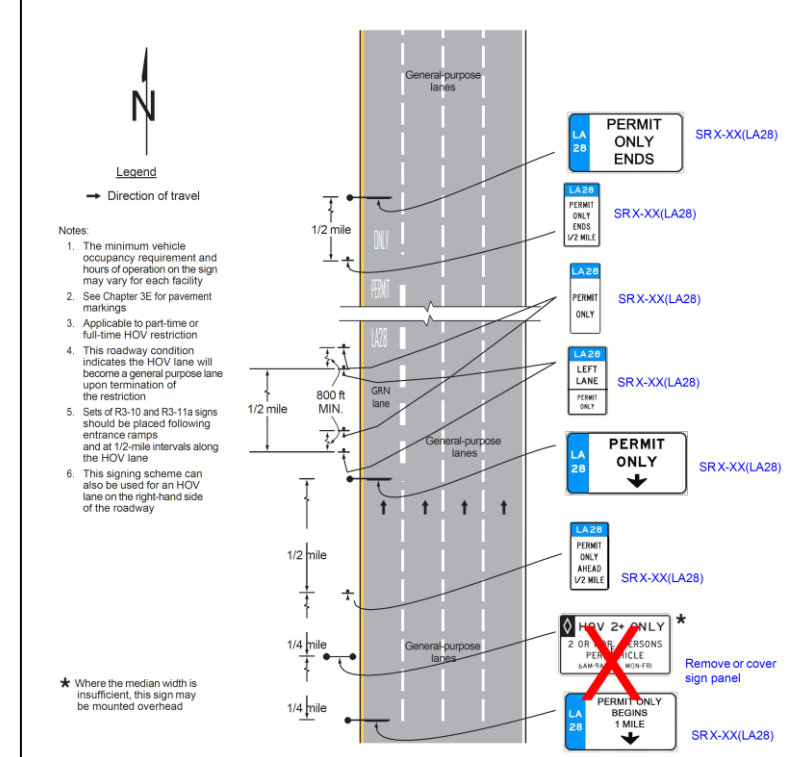

Figure 2G-1003(LA28). Example of Signing for a General-Purpose Lane that Becomes a Games Route Network Lane (Former Continuous-Access Contiguous or Buffer-Separated HOV Lane)







DRAFT



## ✓ 2G.100X – Managed Lane Signs & Plaques

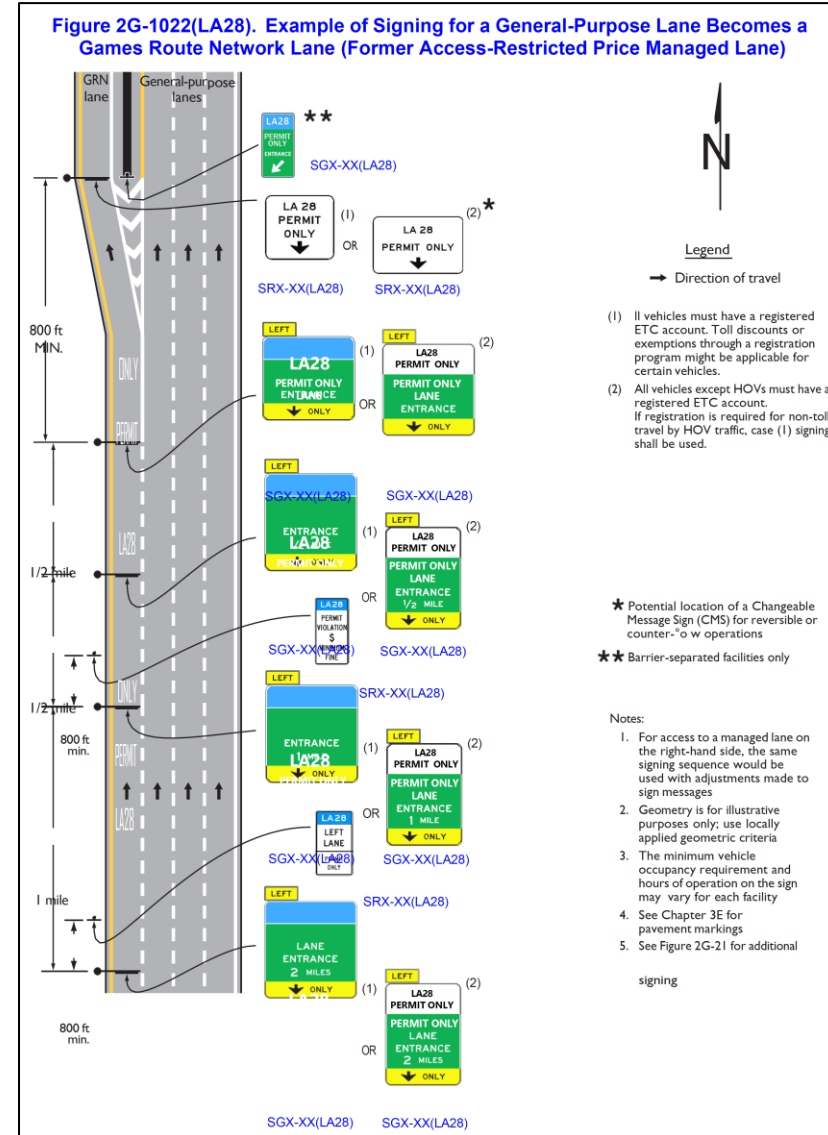
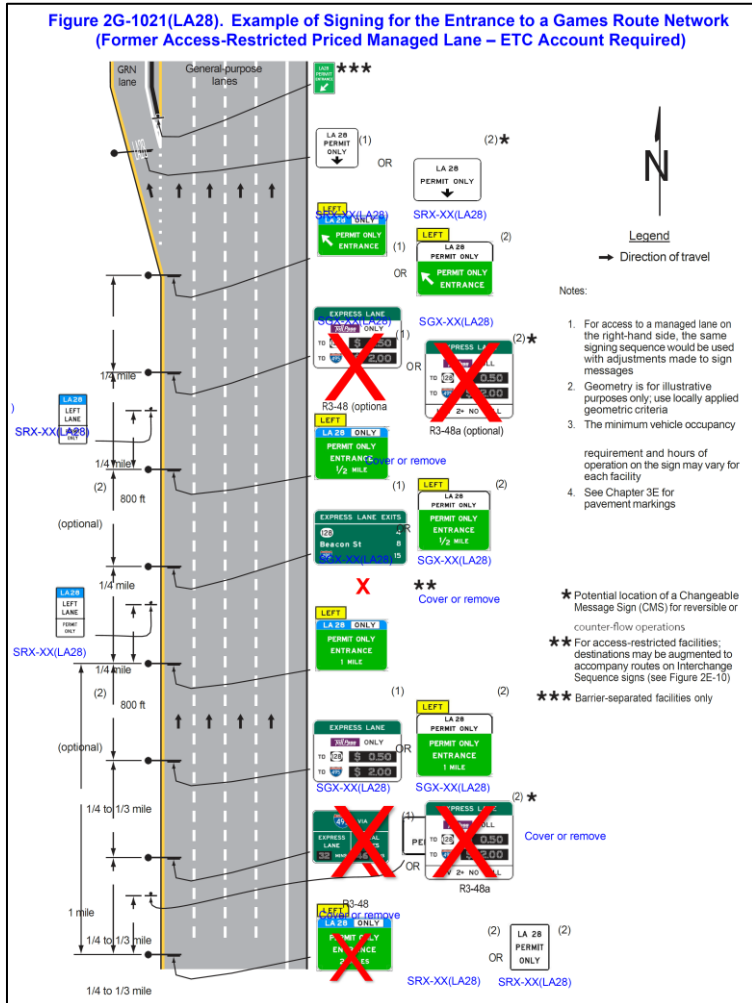



# MUTCD CA SUPPLEMENT

DRAFT



## ✓ 2L.1001 – Changeable Message Signs

**Table 1D-2. Abbreviations that Shall be Used Only for Temporary Messages on Portable Changeable Message Signs (Sheet 1 of 2)**

Word Message	Standard Abbreviation	Prompt Word Preceding the Abbreviation	Prompt Word Following the Abbreviation	Example
Games Route Network	GRN	Use	—	USE GRN
Los Angeles 2028	LA28		Permit	LA28 PERMIT ONLY

**Table 2L-1003(LA28). Examples of Message Games Route Network for CMS**

Example	Phase	Message	Comments
1	1	LA28 PERMIT ONLY AHEAD	Advance warning message: TBD
	2	LA28 PERMIT ONLY LEFT LANE	
2	1	[Redacted]	
	2	[Redacted]	

**Table 2L-1004(LA28). Examples of Message Games Route Network for Portable CMS\***

Example	Phase	Message	Comments
1	1	LA28 PERMIT ONLY	Advance warning message: TBD
	2	LA28 LEFT LN AHEAD	
2	1	[Redacted]	
	2	[Redacted]	

# MUTCD CA SUPPLEMENT

- ✓ 3B.1001 – Pavement markings

Figure 3B-1001(LA28). Examples of Games Route Network Markings

A – LA28 Pavement Marking

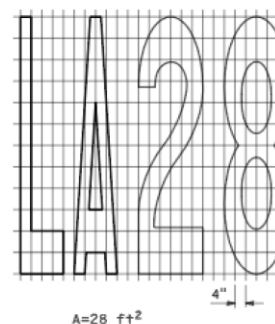

B – LA28 Permit Only at Games Route Network Lane Opening (Freeway) and Arterial streets

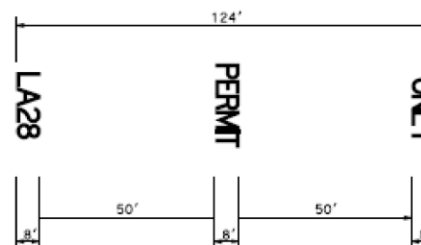

C – LA28 Permit Only at Continuous Games Route Network Lane

