

Dist	COUNTY	ROUTE	POST MILES TOTAL PROJECT	SHEET No.	TOTAL SHEETS
				X	
REGISTERED CIVIL ENGINEER			DATE	X	
PLANS APPROVAL DATE			X		
THE STATE OF CALIFORNIA OR ITS OFFICERS OR AGENTS SHALL NOT BE RESPONSIBLE FOR THE ACCURACY OR COMPLETENESS OF SCANNED COPIES OF THIS PLAN SHEET.					
THE REGISTERED CIVIL ENGINEER FOR THE PROJECT IS RESPONSIBLE FOR THE SELECTION AND PROPER APPLICATION OF THE COMPONENT DESIGN AND ANY MODIFICATIONS SHOWN.					

- NOTES:
- Counter slopes of adjoining gutters and road surfaces immediately adjacent to and within 2'-0" of the curb ramp must not be steeper than 1:20 (5.0%). Gutter pan slope must not exceed 1" of depth for each 2" of width.
 - Transition Pad is only needed when existing/new sidewalk cross slope is steeper than 1.5%. If Transition Pad is needed, then the Barrier Transition will start at the end of the Transition Pad and not at the end of ramp.
 - Curb Ramps must have a running slope not steeper than 7.5% maximum.
 - Transitions from ramps and landing to sidewalks, gutters or streets must be flush (no lip) and free of abrupt changes.
 - Curb Ramps must have a detectable warning surface that extends the full width and 3'-0" depth of the ramp. Detectable Warning Surfaces must conform to the details on this plan and the requirements in the Standard Specification.

LEGEND:
 ----- Existing Structure

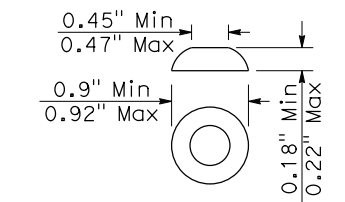

RAISED TRUNCATED DOME

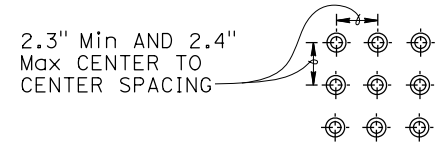

RAISED TRUNCATED DOME PATTERN (IN-LINE)
 DETECTABLE WARNING SURFACE

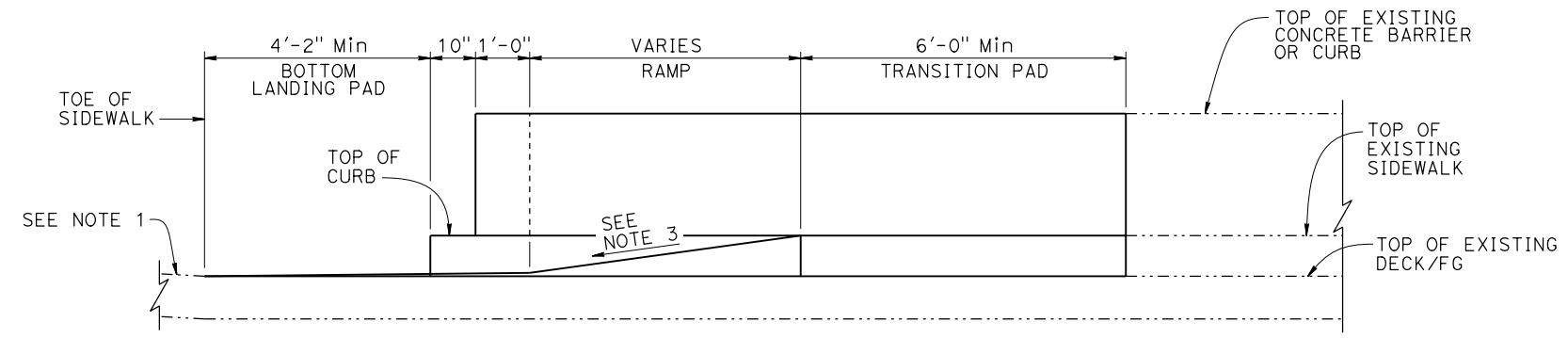

VIEW A-A

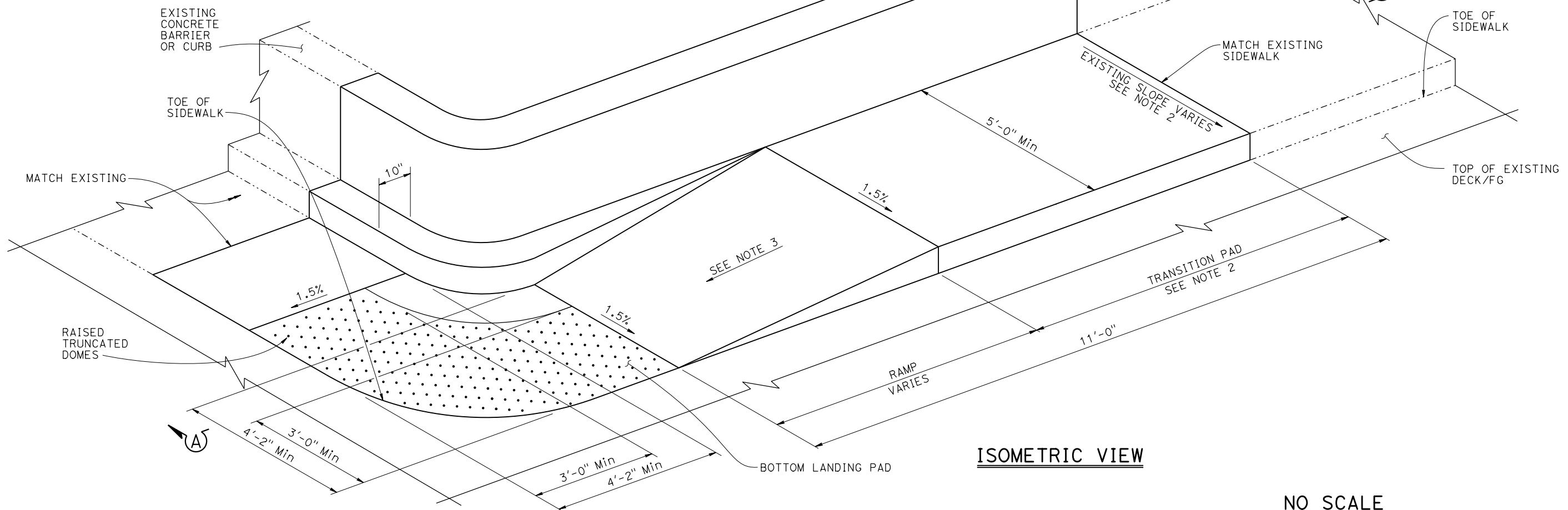

ISOMETRIC VIEW

NO SCALE

BRIDGE STANDARD DETAILS		The components of the Bridge Standard Details have been prepared under the responsible charge of the Technical Owner, a registered civil engineer in the State of California.	STATE OF CALIFORNIA DEPARTMENT OF TRANSPORTATION	DIVISION OF ENGINEERING SERVICES	BRIDGE No.	COUNTY/ROUTE/ZONE: XXX/XXX/X CONTRACT No.: XX-XXXXX4	CURET RAMP CASE 3 DETAILS No. 1
xs19-030-1	September 2023				XX-XXXX		
FILE NO.	APPROVAL DATE				POST MILE		
					X.X		
Refer to: http://www.dot.ca.gov/hq/esc/techpubs/manual/bridgemanuals/bridge-standard-detail-sheets/index.html		DATE PLOTTED => 21-SEP-2023	TIME PLOTTED => 14:58	ORIGINAL SCALE IN INCHES FOR REDUCED PLANS	UNIT: XXXX	DISREGARD PRINTS BEARING EARLIER REVISION DATES	REVISION DATES
		FILE => 201510-xs19-030-1.dgn	USERNAME => s136247	0 1 2 3	PROJECT NUMBER & PHASE: XXXXXXXXXX1		SHEET OF
							X X