

Dist	COUNTY	ROUTE	POST MILES TOTAL PROJECT	SHEET No.	TOTAL SHEETS
03	Pla	65	R11.9/R24.1		

REGISTERED CIVIL ENGINEER DATE

PLANS APPROVAL DATE

THE STATE OF CALIFORNIA OR ITS OFFICERS OR AGENTS SHALL NOT BE RESPONSIBLE FOR THE ACCURACY OR COMPLETENESS OF SCANNED COPIES OF THIS PLAN SHEET.

NOTE:
DRAINAGE SYSTEMS WITH "REMOVAL ONLY" ARE NOT SHOWN.
SEE DRAINAGE QUANTITIES SHEETS FOR INFORMATION.

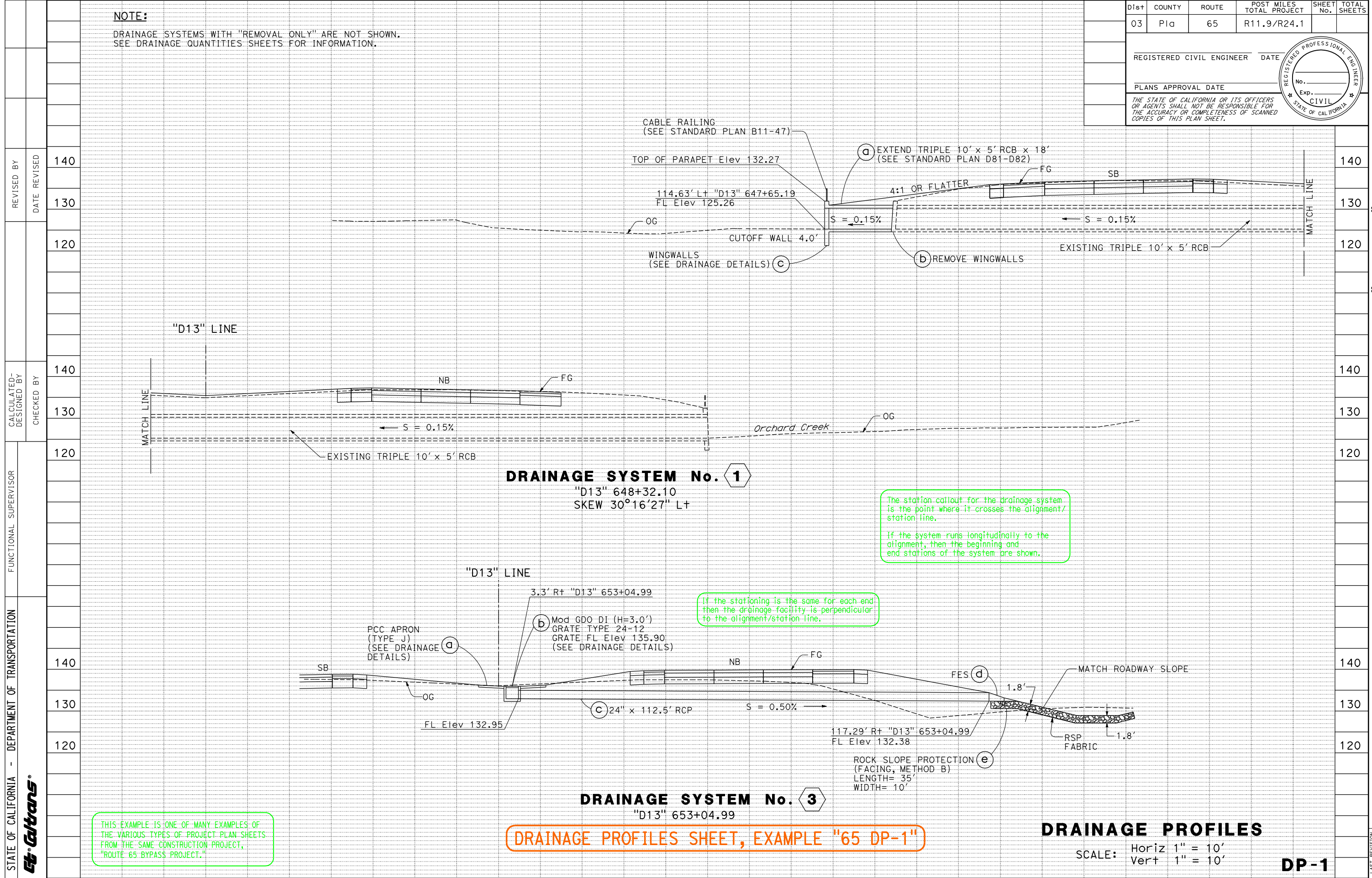

The station callout for the drainage system is the point where it crosses the alignment/station line.
If the system runs longitudinally to the alignment, then the beginning and end stations of the system are shown.

If the stationing is the same for each end then the drainage facility is perpendicular to the alignment/station line.

THIS EXAMPLE IS ONE OF MANY EXAMPLES OF THE VARIOUS TYPES OF PROJECT PLAN SHEETS FROM THE SAME CONSTRUCTION PROJECT, "ROUTE 65 BYPASS PROJECT."

DRAINAGE PROFILES SHEET, EXAMPLE "65 DP-1"

DRAINAGE PROFILES

SCALE: Horiz 1" = 10'
Vert 1" = 10'

DP-1

DRAINAGE PROFILES SHEET, EXAMPLE "65 DP-1" RELEASED 1/6/2012